



EMULATION TECHNOLOGY, INC.

Specification Number: M1208

# PROGRAMMING ADAPTER SPECIFICATION

Item: 404001TS600YAMR  
Description: AS-40-40-01TS-6YAM-GANG-R

## REPLACEMENT SOCKET: S-TSO-00-040-A

Call Emulation Technology for a replacement socket price and delivery quote.

### TYPICAL DIMENSIONS:

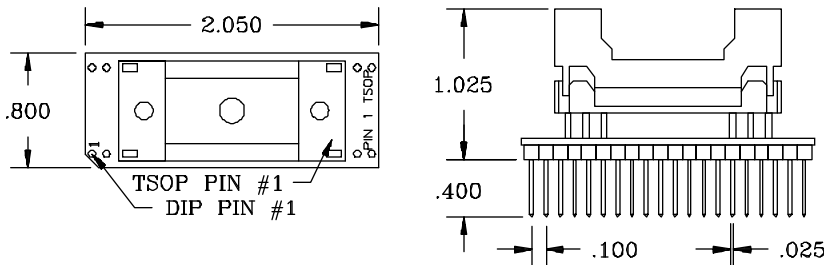

All Dimensions in Inches.

(Assembly Drawing: F1208)

### CONNECTION TABLE:

40-Lead TSOP SOCKET	PIN Names	40-Pin DIP Base
1	NC	7
2	NC	6
3	WE#	39
4	OE#	20
5	RY/BY#	4
6	DQ7	12
7	DQ6	13
8	DQ5	14
9	DQ4	15
10	V <sub>CC</sub>	40
11	GND	11
12	GND	30
13	DQ3	16
14	DQ2	17
15	DQ1	18
16	DQ0	19
17	A0	21
18	A1	22
19	A2	23
20	A3	24
21	A4	25
22	A5	26
23	A6	27
24	A7	28
25	A8	29
26	A9	31
27	A10	32
28	A11	33
29	RP#	3
30	V <sub>PP</sub>	1
31	V <sub>CC</sub>	40
32	CE#	2
33	A12	34
34	A13	35
35	A14	36
36	A15	37
37	A16	38
38	A17	10
39	A18	9
40	A19	8

### PACKAGE SPECIFICATIONS:

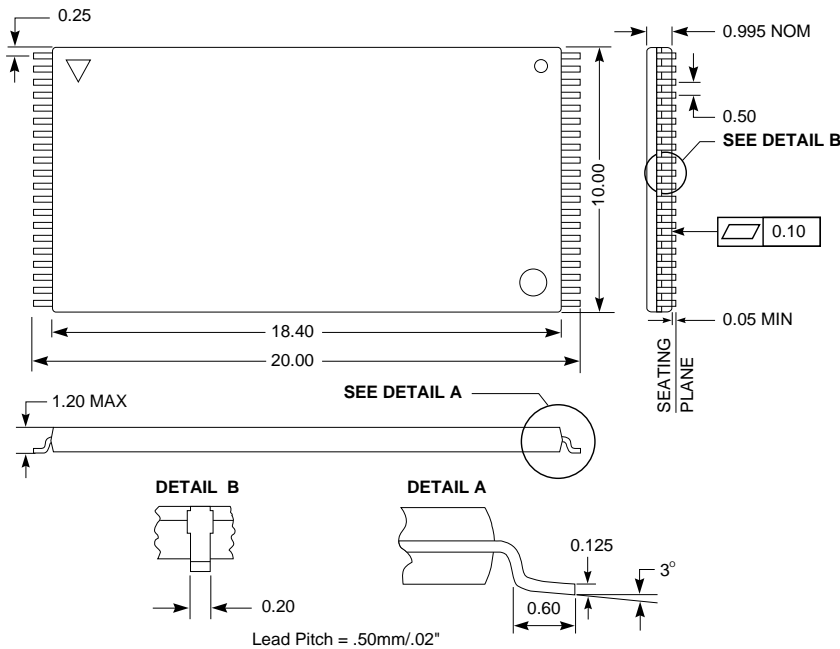

All Dimensions in Millimeters.

ET Code: 040-TS01

#### Compatible TSOP device:

F28F008SA  
F28F008SA-L

#### Manufacturer:

Intel

#### Programmers:

Advin Systems: Pilot-U84/40, Pilot-145/4  
 Aval Data: PKW-5100  
 B&C Microsystems: Proteus  
 BP Microsystems: BP-1200(SM48D), BP-1148, EP-1140  
 Bytek: EZ-FT  
 Data I/O: ChipLab-48, UniSite(SetSite)  
 E.E. Tools: AllMax, AllMax  
 Emulation Technology, Inc.: ET-PIC 4000/48  
 and ET-PIC 1000/48

Elan: 6000, 4000/5000 TURBO, 3000/4000/5000

Logical Devices: AllPro-88XR/88/40, Chipmaster 3000,  
and GangPro-SII

Needham's Electronics: EMP20

SMS: Sprint PLUS48/Optima/Expert/MultiSyte

Stag: Quasar-1040/1084

System General: Multi-APRO, APRO, TURPRO-1/-1FX,  
and TURPRO-840



EMULATION TECHNOLOGY, INC.

2344 WALSH AVENUE • BUILDING F  
SANTA CLARA, CA 95051-1301

TEL 408 / 982.0660 • FAX 408 / 982.0664

Call today for a FREE Full Line Catalog  
and Unlimited Application Consulting!